

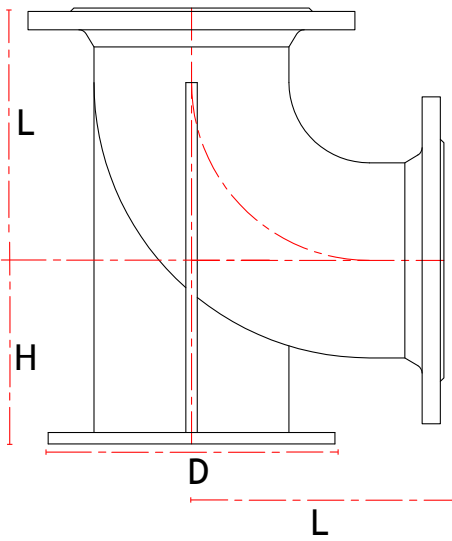

DOUBLE FLANGED

F7.1

90 DEGREE DUCK FOOT BEND

CLASS K12
STANDARD
BS EN 545/598 ISO 2531

Diameter	Dimension 'L'	Dimension 'H'	Base 'D'	Weight	CSG Reference
(mm)	(mm)	(mm)	Square (mm)	(Kg)	
80	165	110	180	14	F080B90DF
100	180	125	200	18	F100B90DF
150	220	160	250	31	F150B90DF
200	260	190	300	47	F200B90DF
250	350	225	350	76	F250B90DF
300	400	255	400	108	F300B90DF
350	450	290	450	150	F350B90DF
400	500	320	500	201	F400B90DF
450	550	350	550	261	F450B90DF
500	600	385	600	336	F500B90DF
600	700	450	700	522	F600B90DF
700	800	515	800	708	F700B90DF
800	900	580	900	974	F800B90DF
900	1000	645	1000	1290	F900B90DF
1000	1100	710	1100	1698	FZ10B90DF

OPTIONS

- EN598
- EN545

Please remember to order gaskets

Technical drawings for illustrative purposes only. Actual product may be subject to minor design changes without notice.



Head Office
Langley Road South,
Salford,
Manchester M6 6TZ

T: +44 (0) 161 745 9095
F: +44 (0) 161 745 8996