



DOUBLE FLANGED

F9.1

CAST PIPE

CLASS K12

STANDARD

BS EN 545/598 ISO 2531

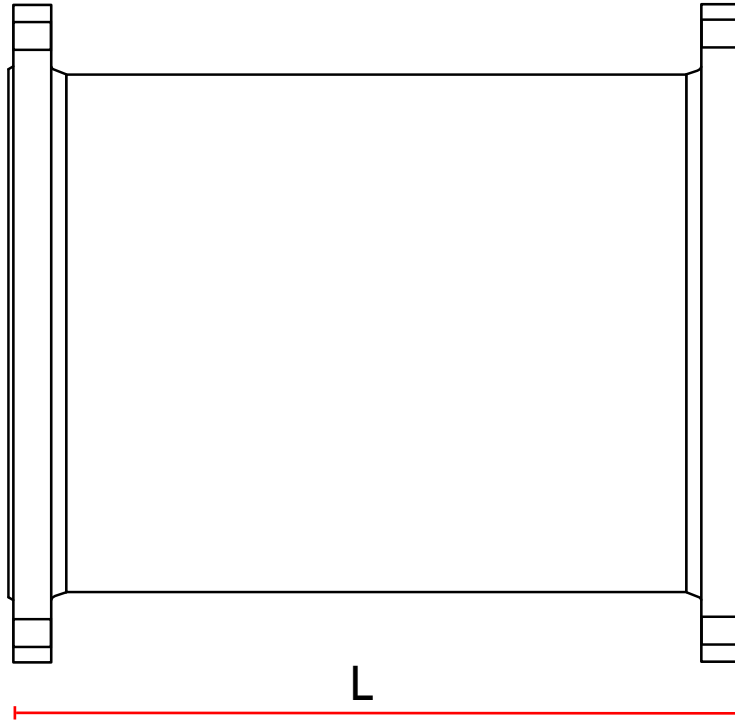

OPTIONS

- EN598
- EN545

Please remember to order gaskets

Technical drawings for illustrative purposes only. Actual product may be subject to minor design changes without notice.



Head Office

Langley Road South,
Salford,
Manchester M6 6TZ

T: +44 (0) 161 745 9095

F: +44 (0) 161 745 8996



F9.1

Diameter (mm)	Length 'L' (mm)	Weight (Kg)	CSG Reference
80	100	6.5	F080CP0100
80	150	7.8	F080CP0150
80	200	8.4	F080CP0200
80	250	9.1	F080CP0250
80	300	10.5	F080CP0300
80	350	9.8	F080CP0350
80	400	11.1	F080CP0400
80	450	11.7	F080CP0450
80	500	12.4	F080CP0500
80	600	13.7	F080CP0600
80	1000	19	F080CP1000
100	100	9	F100CP0100
100	150	9.2	F100CP0150
100	200	10.1	F100CP0200
100	250	11	F100CP0250
100	300	11.9	F100CP0300
100	350	12.7	F100CP0350

**Head Office**

Langley Road South,
Salford,
Manchester M6 6TZ

T: +44 (0) 161 745 9095

F: +44 (0) 161 745 8996

150	400	21	F150CP0400
150	450	22.5	F150CP0450
150	500	24.8	F150CP0500
150	600	26.5	F150CP0600
150	1000	37.5	F150CP1000
200	200	21	F200CP0200
200	300	24	F200CP0300
200	400	27.5	F200CP0400
200	500	31	F200CP0500
250	200	29	F250CP0200
250	300	33	F250CP0300
250	500	42	F250CP0500
300	300	50	F300CP0300
300	500	59	F300CP0500