



DOUBLE SOCKET

S4.1

90 DEG BEND

CLASS K12

STANDARD

BS EN 545/598 ISO 2531

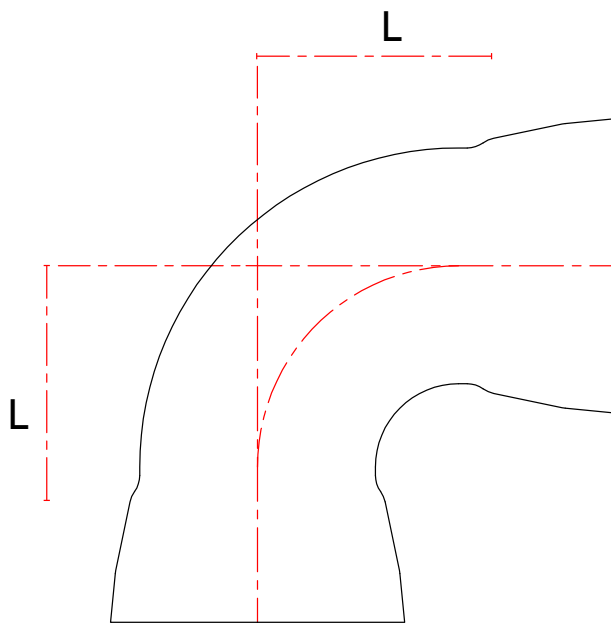

OPTIONS

- EN598
- EN545

Diameter (mm)	Length 'L' (mm)	Weight (Kg)	CSG Reference
80	100	7	T080B90
100	120	10	T100B90
150	170	17	T150B90
200	220	29	T200B90
250	270	43	T250B90
300	320	63	T300B90
350	370	83	T350B90
400	420	113	T400B90
450	470	143	T450B90
500	520	183	T500B90
600	620	273	T600B90
700	720	440	T700B90
800	820	595	T800B90
900	920	800	T900B90
1000	1020	990	TZ10B90

Please remember to order gaskets

Technical drawings for illustrative purposes only. Actual product may be subject to minor design changes without notice.



Head Office

Langley Road South,
Salford,
Manchester M6 6TZ

T: +44 (0) 161 745 9095

F: +44 (0) 161 745 8996